

**SCHOOL DISTRICT OF MANAWA  
BUILDINGS & GROUNDS COMMITTEE MEETING  
AGENDA**

**Join with Google Meet**

meet.google.com/hhj-hcxe-reh

**Join by phone**

(US) +1 862-801-0732 PIN: 121 579 414#

**Date: February 22, 2022**

**Time: 4:00 p.m.**

**Hybrid Meeting Format (In-person Meeting for Board of Education at MES Board Room, 800 Beech Street & Virtual Components)**

**Board Committee Members: R. Johnson (C), Griffin, Hollman**

**In Attendance:**

**Timer:** \_\_\_\_\_ **Recorder:** \_\_\_\_\_

1. Lawn Care Weed & Feed Request for Proposal (Information / Action)
2. Schedule reseeding of new green spaces (Information / Action)
3. Review Football Field Drainage Related to Track Upgrades (Information / Action)
4. Review MES Playground Plan (Information)
5. Discuss Plans to Upgrade Lighting in West MS/HS Parking Lot (Information / Action)
6. Continue to Brainstorm and Prioritize 2022-23 Fiscal Year Projects as Presented (Information /Action)
7. Determine Whether to Secure Quotes for Added Long-Jump (Information / Action)
8. Update on Maintenance (Information)
  - a. Gym (both) Floor Refinishing - Week of July 11
  - b. New Mirrors in the Fitness Center
  - c. Generator Annual Maintenance Contracts - Wolter
  - d. 3CX Phone System
  - e. MES Lighting Proposal
  - f. MES Vinyl Tile
  - g. MS/HS Library
  - h. Review of Project Spreadsheet
  - i. Other
9. Review of Buildings and Grounds Budget
10. Buildings & Grounds Committee Planning Guide (Information)
11. Set Next Meeting Date: \_\_\_\_\_
12. Next Meeting Items:

- a. Long-term Maintenance Plan - Pfefferle as Presented [Operation Efficiencies] (Information / Action)
  - b. Custodial/Maintenance Plan - Pfefferle as Presented (Information / Action)
  - c. School Forest New Management Plan (Information / Action)
  - d. Finalize Review of Key Performance Indicators (Information / Action)
  - e.
13. Adjourn



**Students choosing to excel; realizing their strengths.**

# The School District of Manawa

2022

## LAWN CARE RFP

## **SECTION I – INTRODUCTION and INTENT of RFP:**

### **Notice to Vendors**

**Sealed proposals (postal mail or electronic) will** be received by the District Office for the School District of Manawa (SDM), Manawa, Wisconsin from experienced, qualified vendors who specialize in commercial Lawn Care and Maintenance Services.

Proposals will be accepted until **Friday, September 27, 2022 at 12:00 P.M.** in the District Office. Complete specifications and instructions are attached herewith.

The SDM plans to contract for Lawn Care and Maintenance Services at up to five (5) different sites within the district. This Request for Proposal is for Lawn Care and Maintenance Services ONLY. We expect the selected Contractor to begin work in mid-April 2023, weather permitting.

Proposals shall be submitted in a sealed envelope or electronically identifying the Contractor's name, the RFP title, and the RFP due date.

Submission of a proposal signifies the Contractor's agreement that the proposal and the content thereof are valid and all pricing submitted with the proposal shall remain in effect for the contract period.

The School District of Manawa would like to enter into a three (3)-year agreement but does retain the right to adjust the length of the agreement with the Contractor pending district satisfaction.

## **SECTION II – SCHEDULE:**

### **The School District of Manawa**

#### **Lawn Care Services Request for Proposal Schedule**

<b>Monday, August 26, 2022</b>	RFP available and placed on district website.
<b>Friday, September 20, 2022 by 1:00 P.M.</b>	Last day for questions. Questions must be signed and submitted in writing by 1:00 P.M. Questions may be delivered either by mail, e-mail, or in person.
<b>Friday, September 27, 2022 by 12:00 P.M.</b>	Proposal receipt deadline. All proposals are due at the District Office by 12:00 PM. No late proposals will be accepted.
<b>Wednesday, October 2, 2022 at 6:00 P.M.</b>	Proposals will be opened by the Board of Education Buildings and Grounds Committee along with district administration in the Board Room located at 800 Beech Street in Manawa, Wisconsin.
<b>September 17, 2022 (or thereafter)</b>	Vendor is notified of Award decision.

<b>Mid-April 2023 (weather permitting)</b>	Begin Services
--	----------------

DRAFT

### **SECTION III -- BACKGROUND:**

The School District of Manawa is soliciting proposals for Lawn Care and Maintenance Services for the locations listed below.

#### **FACILITY LOCATIONS CHART**

<b>LOCATION</b>	<b>ADDRESS</b>	<b>SQUARE FOOTAGE OF GREEN SPACE</b>	<b>SITE #</b>
<b>MANAWA ELEMENTARY SCHOOL</b>	<b>800 BEECH STREET</b>	<b>195,637</b>	<b>1</b>
<b>LITTLE WOLF HIGH SCHOOL/MANAWA MIDDLE SCHOOL</b>	<b>515 EAST 4<sup>TH</sup> STREET</b>	<b>271,854</b>	<b>2</b>
<b>MANAWA ATHLETIC COMPLEX</b>	<b>515 EAST 4<sup>TH</sup> STREET</b>	<b>94,649</b>	<b>3</b>
<b>PRACTICE FIELDS</b>	<b>585 EAST 4<sup>TH</sup> STREET</b>	<b>72,968</b>	<b>4</b>
<b>VACANT DISTRICT LOT</b>	<b>585 EAST 4<sup>TH</sup> STREET</b>	<b>368,625</b>	<b>5</b>

**SECTION IV -- GENERAL CONDITIONS and FINANCIAL PROVISIONS:**

**CONTRACTOR QUALIFICATIONS:** The successful Contractor shall have been in the Lawn Care and Maintenance business for a minimum of two (2) years. The Contractor shall have a person available during normal business working hours to address any problems or complaints.

**PRICING:** The Contractor warrants that the pricing stated herein shall remain firm for a period of one (3) SEASONS from Mid-April, 2023 to late October, 2025. Pricing shall include all charges that may be imposed in fulfilling the work.

**SIGNED PROPOSAL CONSIDERED AN OFFER:** Receipt of a signed proposal shall be considered an offer on the part of the Contractor. The terms, conditions, and specifications of this proposal will become part of the contract, if the proposal shall be deemed approved and accepted by the School District of Manawa. In the event of a default on the part of the Contractor after acceptance, the district may take such action as it deems appropriate including legal action for damages or specific performance.

**PAYMENT TERMS:** Payment terms are 45 days following receipt of correct invoice. Voucher invoices must be submitted to:

School District of Manawa  
Attn: Carmen O'Brien – Business Manager  
800 Beech Street  
Manawa, WI 54949 - 8664

**SUBCONTRACTING:** The Contractor shall not have the right or power to assign, subcontract, or transfer interest in this contract. The Contractor is prohibited from subcontracting any services covered in the scope of work.

**CHANGES:** The School District of Manawa shall have the right, at any time, to alter the specifications to meet increased or decreased needs. If any such changes cause an increase or decrease in the cost or the time required for the performance, or otherwise affects any other provision of this agreement, an equitable adjustment shall be made and this agreement shall be modified in writing accordingly.

**NON-DISCRIMINATION:** The Contractor, as an arm of the School District of Manawa, shall not discriminate against individuals on the basis of race, color, national or ethnic origin, ancestry, age, religion or religious creed, disability or handicap, sex or gender, gender identity and/or expression (including a transgender identity), sexual orientation, military or veteran status, genetic information, or any other characteristic protected under applicable federal, state or local law.

**COST FOR PROPOSAL PREPARATION:** Any costs incurred by Contractors in preparing or submitting proposals are the Contractors' sole responsibility. The School District of Manawa will not reimburse any Contractor for any costs incurred prior to award of this contract.

**TIME FOR ACCEPTANCE:** Each proposal shall state that it is a firm offer which may be accepted within a period of 60 days following the submittal date, September 27, 2019. Although the contract is expected to be awarded prior to that time, the 60-day period is requested to allow for unforeseen delays or problems.

**RIGHT TO SUBMITTED MATERIAL:** All responses, inquiries, or correspondence relating to or in reference to this Request for Proposals, and all other reports, charts, displays, schedules, exhibits, and other documentation submitted by the Contractors shall become the property of the School District of Manawa when received.

**COLLUSIVE BIDDING:** The vendor's signature on the School District of Manawa "Request for Proposal (RFP)" is a guarantee that the prices quoted have been arrived at without collusion with other eligible Contractors and without effort to preclude the district from obtaining the lowest possible competitive price.

**LABOR STANDARDS:** The contractor must comply with all local, state and federal rules, including but not limited to the Occupational Safety and Health Act of 1970, the Contract Hours and Safety Standards Act, and the Wisconsin State Labor Law with respect to hours of work, posting of notices, deductions and wages.

The Contractor shall indemnify and save harmless the district from any claim alleging a violation of the Labor Laws of the State of Wisconsin, including but not limited to, the Contractor's obligation to pay prevailing wage.

The Contractor shall make provisions for disability benefits, workers compensation, unemployment insurance, social security, as required by law.

**GENERAL INDEMNITY:** The Contractor shall save and hold harmless, pay on behalf of, protect, defend, indemnify the School District of Manawa, assume entire responsibility and liability for losses, expenses, demands and claims in connection with or arising out of any injury, or alleged injury (including death) to any person, or damage, or alleged damage, to property of the School District of Manawa or others sustained or alleged to have been sustained in connection with or to have arisen out of or resulting from the performance or the intended performance of any work/service, outlined or resulting from this agreement, by the Contractor or their employees, including losses, expenses or damages sustained by the School District of Manawa, as well as the School District of Manawa employees, from any and all such losses, expenses, damages, demands and claims. The Contractor further agrees to defend any suit or action brought against the School District of Manawa based on any such alleged injury or damage and to pay all damages, cost and expenses in connection therewith or resulting there from. As an integral part of this agreement, the Contractor agrees to purchase and maintain, during the life of this contract, contractual liability insurance in the amounts required in the



general liability insurance requirements. The obligations of the Contractor pursuant to this paragraph shall not be limited in any way by any limitation in the amount or type of proceeds, damages, compensation, or benefits payable under any policy of insurance or self-insurance maintained by or for the use and benefit of the Contractor.

**CONFLICT OF INTEREST:** All Contractors must disclose in writing with their proposal the name of any owner, officer, director, or agent who is also an employee/Board of Education Member of or related to an employee/Board of Education Member of the School District of Manawa. By submitting a proposal, the Contractor certifies that there is no relationship between the Contractor and any person or entity which is or gives the appearance of a conflict of interest related to this RFP.

**ERRORS AND OMISSIONS:** The Contractor shall not take advantage of any errors or omissions in this RFP. The Contractor shall promptly notify the School District of Manawa of any omissions or errors found in this document.

**INSURANCE COVERAGE:** During the term of the contract, the Contractor at their sole cost and expense shall provide commercial insurance of such type and with such terms and limits as may be reasonably associated with the contract. At a minimum, the Contractor shall provide and maintain the following coverage and limits:

- **Worker's Compensation** - The Contractor shall provide and maintain Worker's Compensation Insurance, as required by the laws of Wisconsin, as well as employer's liability coverage with minimum limits of \$500,000.00, per occurrence and \$1,000,000.00 in the aggregate. This insurance must include and cover all of the Contractor's employees who are engaged in any work under this contract.
- **General Liability** – The Contractor shall provide and maintain General Liability Coverage at a rate no less than \$1,000,000 per occurrence for bodily injury, personal injury and broad form property damage, product liability, independent contractors (if any), completed operations and contractual liability.
- **Automobile** - Automobile Liability Insurance to include liability coverage, covering all owned, hired and non-owned vehicles used in connection with this contract. The minimum combined single limit shall be \$1,000,000.00 bodily injury and property damage; \$500,000.00 uninsured/under-insured motorist; and \$5,000.00 medical payment.
- **All Risk Property Coverage** – Contractor shall secure, pay for at its sole cost and maintain whatever All Risk Property Coverage Insurance Contractor may deem necessary to protect Contractor against loss of owned or rental capital equipment and tools. The requirement to secure and maintain such insurance is solely for the benefit of the Contractor. Contractor's failure to secure such insurance and/or to maintain adequate levels of coverage shall not obligate the School District of Manawa, its agents or employees, for any losses. Any such insurance policy shall include a waiver if subrogation clause as follows: "It is agreed that in no event shall this insurance company have any right to recovery against the School District of

Manawa and the School District of Manawa is to be held harmless by the Insured and this Insurance carrier.

**INSURANCE REQUIREMENTS:** Providing and maintaining adequate insurance coverage is a material obligation of the Contractor and is of the essence of this contract. All such insurance shall meet all laws of the State of Wisconsin.

**OTHER INSURANCE PROVISIONS:** The policy or policies are to contain, or be endorsed to contain, the following provisions:

- A. Contractor's insurance is for losses that occur as a direct result of the Contractor's actions. Contractors insurance shall contain endorsements for "primary & non- contributory."
- B. Coverage shall state that the Contractor's insurance shall not be suspended, voided, canceled, reduced in coverage or in limits except after 30 days written notice.
- C. Waiver of Subrogation endorsements.

The Contractor must include a copy of their insurance certificate with their proposal package. Upon award of this contract, the selected Contractor shall add the School District of Manawa as "additional insured" to their insurance policy.

**PROPOSAL OPENING:** The proposal deadline is Friday, September 27, 2019 at 12:00 P.M. On Wednesday, October 3, 2019 at 6:00 P.M. in the Board Room located at 800 Beech Street in Manawa, Wisconsin, the package containing the proposals from each responding Contractor will be publicly opened. At that time the name of the Contractor and the cost(s) offered will be announced. This is an open and public meeting. Interested parties may attend. However, it must be noted that these costs and their components are subject to further evaluation for completeness and correctness. Therefore, the cost(s) announced at that time may not be an exact indicator of the Contractor's pricing position. Neither can the assumption be made that the Contractor with the lowest price offered will be awarded the contract. See "**EVALUATION CRITERIA**" and "**AWARD OF BID**" for further explanation on the components involved with the award of this contract.

**EVALUATION CRITERIA:** The School District of Manawa, at its sole discretion, following an objective evaluation, will award this contract to the most responsible, responsive Contractor. The proposals will be evaluated on a "best overall value" basis including, but not limited to, completeness and content of the proposal, pricing, quality, the Contractors ability to follow the specifications, the Contractors ability to provide a team of skilled, trained employees, the Contractors experience with similar projects and the Contractors responses to "Mandatory Issues". In addition to these considerations, the evaluators may request additional information, oral presentations or discussions with any or all of the responding Contractors to clarify elements of their proposal or to amplify the materials presented in any part of the proposal. However, Contractors are cautioned that the evaluators are not required to request clarification; therefore, all proposals should be complete and reflect the most favorable terms available from the Contractor.

The School District of Manawa reserves the right to make independent investigations as to the qualifications of the Contractor. Such investigations may include contacting existing customers.

Contractors should keep in mind that this is a Request for Proposals and not a request to contract. The School District of Manawa reserves the unqualified right to accept or reject any and all proposals, and to waive any irregularities as may be permitted by law when it is deemed that such action will be in the best interest of the School District of Manawa.

**REFERENCE TO OTHER DATA:** Only information which is received in response to this Request for Proposals will be evaluated. Reference to information previously submitted shall not be evaluated.

**AWARD OF BID:** The School District of Manawa, at its sole discretion, following an objective evaluation, will award this contract to the most responsible, responsive Contractor(s). The district may choose to award portions of the bid to one Contractor (i.e. Athletic Complex) and other portions (i.e. standard lawn care) to another Contractor. Price will be a major consideration but will not be the determining factor in our selection. The award of this contract will be based and granted on **“BEST VALUE.”** **“BEST VALUE”** will allow the School District of Manawa to consider factors beyond pricing such as whether the responsible Contractor(s) is able to meet and/or exceed the required specifications. **“BEST VALUE”** will permit and reflect prudent stewardship of public funds and trust. Award of the contract(s) to one or more Contractor(s) does not mean that the other proposals lacked merit. Award of the contract(s) signifies that after all factors have been considered, the selected proposal(s) was deemed most advantageous to the School District of Manawa.

**NOTIFICATION OF AWARD:** After all prerequisites and specifications have been met by the Contractor and the award for Lawn Care and Maintenance Services has been made, the successful Contractor will be notified within eight (8) working days of this award. The School District of Manawa will notify the successful Contractor in writing, either by a LETTER OF AWARD or a PURCHASE ORDER or both. Verbal notification of the award of this contract is not considered a reliable mode of notification and, therefore, will not be recognized as an official notification. The School District of Manawa does retain the right to enter into a multi-year agreement with the Contractor pending district satisfaction.

**TERMINATION FOR CAUSE:** The School District of Manawa reserves the right to terminate this contract at any time for cause. The violation of any provision or condition contained in this contract, or the refusal, failure, or inability to carry out any provisions of this contract shall constitute sufficient grounds to terminate this contract for cause. Should the School District of Manawa elect to terminate this contract for cause, the School District of Manawa will notify the Contractor 30 days prior to the termination date and shall specify the cause for termination as well as the date the termination shall be effective. This termination notice will be issued via a written letter sent by certified U.S. mail. Immediate dismissals may be executed if deemed necessary by the School District of Manawa.

**TERMINATION WITHOUT CAUSE:** The School District of Manawa and the Contractor may terminate this contract without cause. Written notice of termination must be sent via certified U.S. Mail no later than thirty (30) days prior to the termination date.

## **SECTION V – EMPLOYEE GUIDELINES:**

**DRUG & TOBACCO POLICY:** The Contractor certifies that it maintains a drug-free and tobacco-free workplace environment to ensure worker safety and workplace integrity. The Contractor further agrees their employees shall comply with this policy.

**AUTHORIZED PERSONNEL:** While engaged in the performance of these Lawn Care and Maintenance Services, only authorized employees of the Contractor are allowed at the School District of Manawa location where the work is being performed. During the performance of these services, the Contractor employees are not to be accompanied in the work area by acquaintances, family members, associates or any other person(s) who are not a current, authorized employee(s) of the Contractor.

**EMPLOYEE GUIDELINES:** The Contractor shall use only qualified personnel to provide the required services. The Contractor shall be responsible for ensuring that employees abide by all rules and regulations set forth for the buildings and grounds. In addition, any authorized employee of the Contractor shall submit to a School District of Manawa police background check at the expense of the Contractor.

## **SECTION VI – SAFETY:**

**SAFETY:** The Contractor and any persons employed by the Contractor shall be required to adhere to all OSHA requirements and regulations that apply while performing any part of the work listed under the title “Scope of Work”. The Contractor and any persons employed by the Contractor shall be required to wear the following safety items as required by OSHA regulations while performing any part of the work listed under the title “Scope of Work”. These safety items are: steel-toed boots, gloves, hearing protection, and eye protection.

**State and Federal Regulations:** The Contractor shall perform all work in accordance with State and Federal safety regulations in regards to work zones, work areas, equipment, vehicles, and tools and supplies. The Contractor shall provide all necessary and required work zone protective devices and traffic channeling devices as required under State and Federal safety regulations.

**Public Safety:** The Contractor shall protect the safety and convenience of the general public. The Contractor shall perform work as needed and necessary to protect the general public from hazards.

## **SECTION VII -- SPECIAL CONDITIONS:**

**CONTRACTOR SUPERVISION:** The Contractor or the Contractor’s authorized agent shall make sufficient routine inspections to ensure the Lawn Care and Maintenance work is performed as required by the contract.

## **SECTION VIII – PROPOSAL INFORMATION:**

- Proposals for LAWN CARE and MAINTENANCE SERVICES will be received by the School District of Manawa until Friday, September 27, 2022 at 12:00 P.M. Proposals may be submitted by mail, emailed or delivered in person. **NO** faxed proposals will be accepted. The District Office must receive all proposals at the following location **PRIOR** to the date and time specified. Any proposal received after the date and time prescribed shall **NOT** be considered for award.

Each proposal must be submitted in a sealed envelope, addressed to:

School District of Manawa

Attn: LAWN CARE RFP  
800 Beech Street  
Manawa, Wisconsin 54949 – 8664

Each sealed envelope containing a proposal must be plainly marked with the **“CONTRACTOR’S NAME”, “RFP TITLE”, and the “RFP OPENING DATE & TIME”.**

OR via email to:

[cobrien@manawaschools.org](mailto:cobrien@manawaschools.org)

- The Bid Proposal must be completed, signed, and dated by an official of the company authorized to bind the firm. Unsigned proposals will not be considered.
- Questions regarding this RFP must be submitted in writing directly to Carmen O’Brien, Business Manager.
- All locations must be bid individually.
- All questions in the “Mandatory Questions to be answered” must be fully addressed in the proposal.
- The successful Contractor shall be responsible for having taken steps reasonably necessary to ascertain the nature and location of the work, and the general and local conditions, which can affect the work or the cost thereof. Accuracy of the Contractors proposal should be based on information provided during site visitations and a careful review of the RFP specifications including any addenda. After proposals have been submitted, the Contractor shall not assert there was a misunderstanding concerning the quantity or nature of the work to be performed in

an effort to alter their responsibility to successfully perform the work without additional expense to the School District of Manawa.

- The Contractor to whom this project is awarded shall execute and perform the work as outlined in these specifications and in accordance with all the conditions as described in this RFP.
- Each Contractor and their employees are expected to be trained and experienced in Lawn Care and Maintenance Services on a large scale. When submitting a proposal, the Contractor should include a statement of experience where Lawn Care and Maintenance Services have been performed in similar work situations and environments along with a reference list of Wisconsin school districts currently using the Contractor's services and it should be additionally noted on the reference list where the Contractor also provides for the care of the athletic fields.
- The School District of Manawa may make such investigations deemed necessary to determine the ability of the Contractor to perform the services outlined in these specifications. If requested, the Contractor shall provide the School District of Manawa with all such information and data for this purpose. The School District of Manawa reserves the right to reject any proposal if the evidence submitted by or derived from an investigation of such Contractor fails to satisfy the School District of Manawa that the Contractor is properly qualified to carry out the obligations of the contract and to complete the work specified in this RFP.
- A conditional or qualified proposal will not be accepted.

## **SECTION IX – MANDATORY ISSUES:**

1. **List or detail all pertinent information and data that would indicate the ability of your organization to satisfactorily fulfill the work as outlined in this Request for Proposals.**
2. **Has a member of your management team personally inspected the proposed work sites? Please include a copy of your complete plan for the performance of specified work?**
3. **How will your company supervise your employees during the performance of the work?**

## **SECTION X – BID SHEET:**

### **GENERAL SPECIFICATIONS**

Specifications for lawn care must include the following:

1. A certified agronomist or horticulturist will minimally take one core soil sample from each location once per year and use the analysis of said sample for the purposes of designing the proper soil treatment plan for each location. Uses of the location should be taken into consideration.
2. Proposals will address each site separately using the square footage/acreage by application. A

Contractor may choose to submit a proposal for one site (i.e. Athletic Complex), multiple sites, or all sites.

3. Aerating and overseeding will be combined and quoted as a square footage/acreage price.
4. 25-0-5 fertilizer will be the pricing standard for the proposal.
5. The treatment of broadleaf weeds will be with a 2-4-D or equivalent with application to label specifications.
6. Advanced scheduling of the lawn care applications is required by contacting the District Administrator/Director of Buildings and Grounds- Dr. Melanie J. Oppor. Once applications have been completed, all proper posting of the application will be the responsibility of the Contractor for safety reasons.

DRAFT

## **SIGNATURE SHEET**

\_\_\_\_\_  
Signature

\_\_\_\_\_  
Company Name

Print Name

Company Address

\_\_\_\_\_  
City

\_\_\_\_\_  
St. Zip

\_\_\_\_\_  
Telephone #

\_\_\_\_\_  
Fax #

\_\_\_\_\_  
Federal Tax ID #

\_\_\_\_\_  
URL/Email Address

The above individual must be authorized to sign on behalf of the company submitting the proposal.

Proposals must be signed by an official authorized to bind the provider to its provisions for at least 60 days.

### **SECTION XI – INVOICE SHEET:**

The Contractor shall provide a monthly invoice for services rendered during that one month period. The Contractor shall send that monthly invoice to the Business Office – Attn.: Carmen O’Brien (800 Beech Street Manawa, WI 54949 - 8664). Please provide the list of tasks and date on which work was completed for each site during the month.



CHECKED:	RB
DRAWN:	DP
DATE:	APRIL 3, 2012
PROJECT NO.:	11.091

IRRIGATION PLAN

MANAWA HIGH SCHOOL  
 REDEVELOPMENT PROJECT  
 RUNNING TRACK  
 SCHOOL DISTRICT OF MANAWA  
 WAUPACA COUNTY, WISCONSIN

Land Surveying  
 Engineering  
 5709 Windy Drive, Suite D  
 Stevens Point, WI 54482  
 715.344.9999 (Ph) 715.344.9922 (Fx)

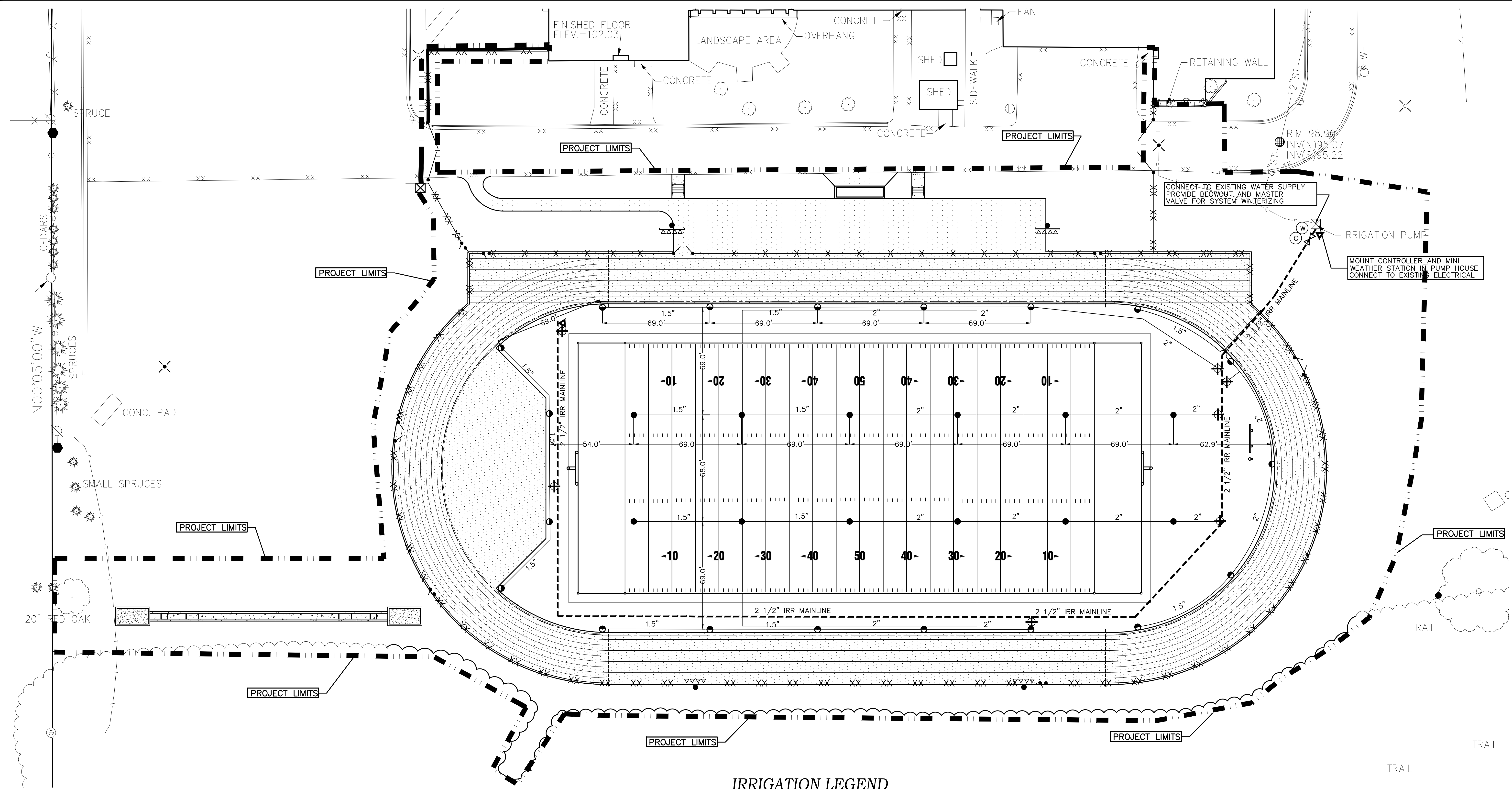
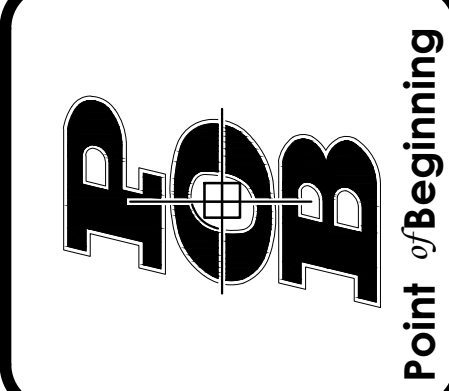

IRRIGATION LEGEND

- HUNTER I-35-06 FULL CIRCLE GEAR DRIVE SPRINKLER OPERATING AT 50 PSI
- HUNTER I-35 ADJUSTABLE GEAR DRIVE SPRINKLER OPERATING AT 50 PSI
- Ⓢ HUNTER ACC-1200 CONTROLLER, MOUNTED IN PUMP HOUSE
- Ⓜ HUNTER MINI WEATHER STATION
- ▼ HUNTER HQ-44-LRC 1" QUICK COUPLER W/KEY
- ⊕ HUNTER ICV-201G-FS SERIES ELECTRIC VALVE
- 2 1/2" CL200 PVC PIPE MAINLINE
- 1.5" PVC OR PE LATERAL LINE, SIZED AS SHOWN
- ⊗ ISOLATION VALVE SIZED TO PIPE

NOTE: Irrigation heads/ lateral lines As-Built locations shall be verified in field

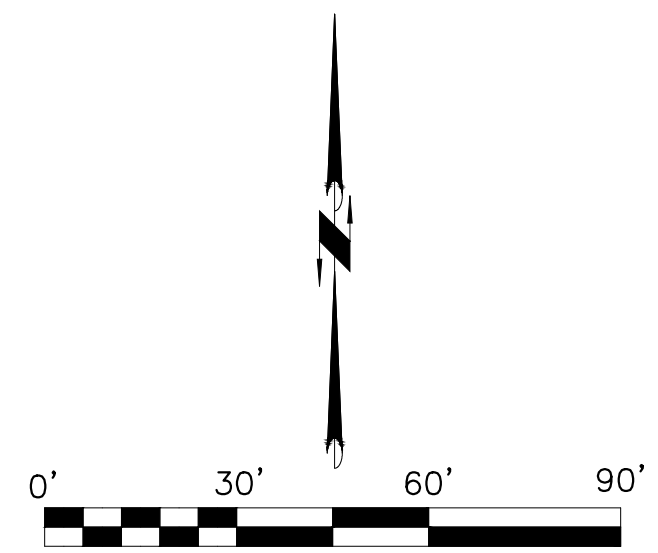

POINT OF BEGINNING, INC. HOLDS THE RIGHTS TO COPYRIGHT IN AND TO THESE PRINTS, DRAWINGS AND DOCUMENTS. NO REPRODUCTION, COPYING, ALTERATION, MODIFICATION, USAGE, INCORPORATION INTO OTHER DOCUMENTS OR ASSIGNMENT OF THE SAME MAY OCCUR WITHOUT THE PRIOR WRITTEN PERMISSION OF POINT OF BEGINNING, INC.  
 ©2011 POINT OF BEGINNING, INC.



## **VISUAL SOIL CLASSIFICATION**

Little Wolf Junior/Senior Football Field

515 East 4<sup>th</sup> Street

Manawa, Wisconsin

Prepared for:

Hoffman Planning, Design & Construction, Inc.

122 East College Avenue, Suite 1G

Appleton, Wisconsin 54911

October 28, 2019

PSI Project No. 0094953-R

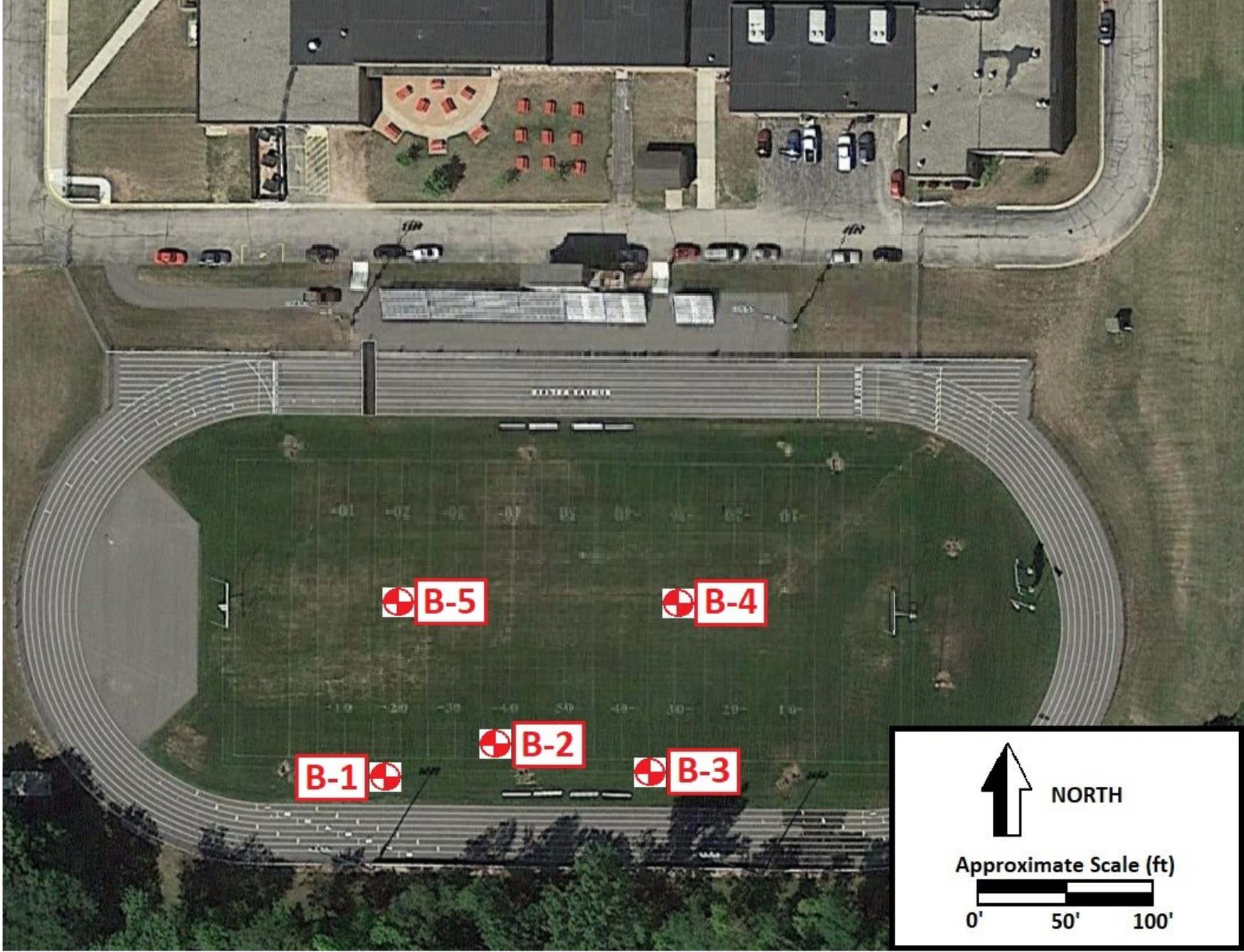

SCALE: SHOWN ABOVE

PROJECT NO: 0094953

PAGE 1 OF 1

Little Wolf Junior/Senior Football Field  
 515 East 4th Street  
 Manawa, Wisconsin

FIGURE 1: BORING LOCATION PLAN





# SOIL BORING LOG: B - 1

**Project:** Little Wolf Junior/Senior Football Field

**Project No.:** 0094953

**Location:** 515 East 4th Street  
Manawa, Wisconsin

**Drill Date:** August 12, 2019  
**Drilled By:** GW/KH

DEPTH/EL. (feet)	VISUAL SOIL CLASSIFICATION GROUND SURFACE ELEVATION: 875.5	SAMPLE NO.	N (bpf)	Qp (tsf)	Qu (tsf)	MC (%)	REMARKS
1	0-6": Dark Brown Sandy CLAY, with trace root matter, moist (TOPSOIL FILL)			-	-	11	∇
1	Brown Medium SAND, wet (FILL)	1-SS	6	-	-	5	
2	Brown Medium to Fine SAND, with trace silt and gravel, moist (FILL)						
3	Reddish brown Sandy CLAY, with trace gravel and dark brown seams, moist (FILL)	2-SS	14	2.5	-	8	
4							
5	870.5						
6	Reddish brown CLAY, with trace gravel, moist	3-SS	9	2.5	2.8	22	↓
7							
8		4-SS	50/3"	4.0	-	10	
9							
10	865.5						
11		5-SS	22	4.5+	5.0	12	
12							
13							
14	Reddish brown Fine SAND, with trace clay, moist	6-SS	23	-	-	13	
15	860.5						
16							
17							
18							
19	Brown Fine SAND, moist	7-SS	10	-	-	5	
20	855.5						
	END OF BORING @ 20± FEET						

<b>FIELD OBSERVATIONS:</b> Water Level during drilling: 6± inches below ground surface (EL. 875.0±) ∇ Water Level upon completion: Not Present ∇ Caved at upon completion: 6± feet below ground surface (EL. 869.5±) ↓ Delay Time: N/A Water Level delayed: N/A ∇ Caved at delayed: N/A	<b>ADDITIONAL COMMENTS:</b>
---	-----------------------------

**Note:** Lines of stratification represent an approximate boundary between soil types. Variations may occur between sampling intervals and/or boring locations. Transitions may also be gradual.



# SOIL BORING LOG: B - 2

**Project:** Little Wolf Junior/Senior Football Field

**Project No.:** 0094953

**Location:** 515 East 4th Street  
Manawa, Wisconsin

**Drill Date:** August 12, 2019  
**Drilled By:** GW/KH

DEPTH/EL. (feet)	VISUAL SOIL CLASSIFICATION GROUND SURFACE ELEVATION: 875.5	SAMPLE NO.	N (bpf)	Qp (tsf)	Qu (tsf)	MC (%)	REMARKS
1	0-6": Dark Brown Sandy CLAY, with trace root matter, moist (TOPSOIL FILL) Brown Medium SAND, wet (FILL) Reddish brown CLAY, with dark brown seams, moist (FILL)	1-SS	6	-	-	14	∇
2							
3	Reddish brown CLAY, with trace gravel, moist	2-SS	12	4.0	5.6	20	
4							
5							
6		3-SS	7	2.3	2.4	22	
7							↓
8		4-SS	15	2.5	3.1	13	
9							
10							
11		5-SS	21	3.5	3.9	13	
12							
13							
14	Brown Medium to Fine SAND, with trace gravel, moist	6-SS	22	-	-	1	
15							
16							
17							
18							
19		7-SS	12	-	-	1	
20	END OF BORING @ 20± FEET						

<b>FIELD OBSERVATIONS:</b> Water Level during drilling: 6± inches below ground surface (EL. 875.0±) ∇ Water Level upon completion: Not Present ∇ Caved at upon completion: 7± feet below ground surface (EL. 868.5±) ↓ Delay Time: N/A Water Level delayed: N/A ∇ Caved at delayed: N/A	<b>ADDITIONAL COMMENTS:</b>
---	-----------------------------

**Note:** Lines of stratification represent an approximate boundary between soil types. Variations may occur between sampling intervals and/or boring locations. Transitions may also be gradual.



# SOIL BORING LOG: B - 3

**Project:** Little Wolf Junior/Senior Football Field

**Project No.:** 0094953

**Location:** 515 East 4th Street  
Manawa, Wisconsin

**Drill Date:** August 12, 2019  
**Drilled By:** GW/KH

DEPTH/EL. (feet)	VISUAL SOIL CLASSIFICATION GROUND SURFACE ELEVATION: 875.5	SAMPLE NO.	N (bpf)	Qp (tsf)	Qu (tsf)	MC (%)	REMARKS
1	0-6": Dark Brown Sandy CLAY, with trace root matter, moist (TOPSOIL FILL)			-	-	16	v
1	Brown Medium SAND, wet (FILL)	1-SS	10	-	-	6	
2	Brown Medium to Fine SAND, with gravel, trace silt, and reddish brown clay seams, moist (FILL)						
3	Brown Sandy CLAY, moist (POSSIBLE FILL)	2-SS	11	2.8	2.8	12	
4							
5	870.5						
6	Brown CLAY, moist (POSSIBLE FILL)	3-SS	7	1.5	2.7	18	↓
7							
8	Reddish brown CLAY, with trace gravel, moist	4-SS	11	2.8	2.5	16	
9							
10	865.5						
11		5-SS	18	4.5+	5.4	12	
12							
13							
14	861.5						
15	Brown Fine SAND, with trace gravel, moist	6-SS	50/2"	-	-	5	
16							
17							
18							
19							
20	855.5	7-SS	14	-	-	4	
END OF BORING @ 20± FEET							

<b>FIELD OBSERVATIONS:</b> Water Level during drilling: 6± inches below ground surface (EL. 875.0±) v Water Level upon completion: Not Present v Caved at upon completion: 7± feet below ground surface (EL. 868.5±) ↓ Delay Time: N/A Water Level delayed: N/A v Caved at delayed: N/A	<b>ADDITIONAL COMMENTS:</b>
---	-----------------------------

**Note:** Lines of stratification represent an approximate boundary between soil types. Variations may occur between sampling intervals and/or boring locations. Transitions may also be gradual.



# SOIL BORING LOG: B - 4

**Project:** Little Wolf Junior/Senior Football Field

**Project No.:** 0094953

**Location:** 515 East 4th Street  
Manawa, Wisconsin

**Drill Date:** August 12, 2019  
**Drilled By:** GW/KH

DEPTH/EL. (feet)	VISUAL SOIL CLASSIFICATION GROUND SURFACE ELEVATION: 876.0	SAMPLE NO.	N (bpf)	Qp (tsf)	Qu (tsf)	MC (%)	REMARKS
1	0-6": Dark Brown Sandy CLAY, with trace root matter, moist (TOPSOIL FILL)			-	-	15	
1	875.0	1-SS	5	-	-	12	
2	874.0						
3	873.0	2-SS	7	1.8	-	11	
4	872.0						
5	871.0						
6	870.0	3-SS	15	4.5	4.0	16	
7	869.0						
8	868.0	4-SS	30	4.3	-	10	
9	867.0						
10	866.0	5-SS	45	1.5	-	11	
11	865.0						
12	864.0						
13	863.0						
14	862.0	6-SS	20	-	-	4	
15	861.0						
16	860.0						
17	859.0						
18	858.0						
19	857.0	7-SS	13	-	-	5	
20	856.0						
END OF BORING @ 20± FEET							

<p><b>FIELD OBSERVATIONS:</b></p> <p>Water Level <small>during drilling</small>: Not Encountered <span style="float: right;">∇</span></p> <p>Water Level <small>upon completion</small>: Not Present <span style="float: right;">▼</span></p> <p>Caved at <small>upon completion</small>: 9± feet below ground surface (EL. 867.0±) <span style="float: right;">⊥</span></p> <p>Delay Time: N/A</p> <p>Water Level <small>delayed</small>: N/A <span style="float: right;">¥</span></p> <p>Caved at <small>delayed</small>: N/A</p>	<p><b>ADDITIONAL COMMENTS:</b></p>
---	------------------------------------

**Note:** Lines of stratification represent an approximate boundary between soil types. Variations may occur between sampling intervals and/or boring locations. Transitions may also be gradual.



# SOIL BORING LOG: B - 5

**Project:** Little Wolf Junior/Senior Football Field

**Project No.:** 0094953

**Location:** 515 East 4th Street  
Manawa, Wisconsin

**Drill Date:** August 12, 2019  
**Drilled By:** GW/KH

DEPTH/EL. (feet)	VISUAL SOIL CLASSIFICATION GROUND SURFACE ELEVATION: 876.0	SAMPLE NO.	N (bpf)	Qp (tsf)	Qu (tsf)	MC (%)	REMARKS
1	0-6": Dark Brown Sandy CLAY, with trace root matter, moist (TOPSOIL FILL)			-	-	10	
1	Dark brown Sandy CLAY, with reddish brown clay seams, moist (FILL)	1-SS	7	1.3	2.4	15	
2							
3							
3	Brown Sandy SILT, moist (POSSIBLE FILL)	2-SS	21	4.5	-	9	
4							
5	871.0						↓
5	Reddish brown CLAY, with trace gravel, moist						
6		3-SS	10	2.5	3.7	19	
7							
8		4-SS	16	4.0	4.1	14	
9							
10	866.0						
11		5-SS	20	4.3	5.4	14	
12							
13							
14		6-SS*	29	-	-	14	
15	861.0						
16							
17							
18							
19	857.0						
19	Brown Fine SAND, with trace gravel, moist	7-SS	25	-	-	4	
20	856.0						
	END OF BORING @ 20± FEET						

<b>FIELD OBSERVATIONS:</b> Water Level during drilling: Not Encountered <span style="float: right;">∇</span> Water Level upon completion: Not Present <span style="float: right;">▼</span> Caved at upon completion: 5± feet below ground surface (EL. 871.0±) <span style="float: right;">↓</span> Delay Time: N/A Water Level delayed: N/A <span style="float: right;">¥</span> Caved at delayed: N/A	<b>ADDITIONAL COMMENTS:</b>  <p style="text-align: center;">* Poor sample recovery.</p>
---	---

**Note:** Lines of stratification represent an approximate boundary between soil types. Variations may occur between sampling intervals and/or boring locations. Transitions may also be gradual.



# GENERAL NOTES

## SAMPLE IDENTIFICATION

- Information on each log is a compilation of subsurface conditions, based on visual soil classifications of soil samples obtained from the field as assigned by a soils engineer, as well as from laboratory testing of samples, if performed. The strata lines on the logs may be approximate or the transition between the strata may be gradual rather than distinct. Water level measurements refer only to those observed at the times and locations indicated, and may vary with time, geologic condition and construction activity.
- Unified Soil Classification System (USCS) designations are based on visual soil classification estimates on the basis of textural and particle size categorization and various soil behavior characteristics. If laboratory tests were performed to classify the soil, the USCS designation is shown in parenthesis.

## USCS SOIL PARTICLE SIZE CLASSES

U.S. Std. Sieve		#200	#40	#10	#4	¾"	3"	12"	
Soil Type	Clay	Silt	Sand			Gravel		Cobbles	Boulders
			Fine	Medium	Coarse	Fine	Coarse		
Millimeters	0.002	0.074	0.42	2	4.8	19	76	300	

## UNIFIED SOIL CLASSIFICATION SYSTEM (ASTM D2487-00)

Criteria for assigning group symbols and group names using laboratory tests <sup>A</sup>				Soil Classification	
				Group Symbol	Group Name <sup>B</sup>
COARSE-GRAINED SOILS (More than 50% retained on No. 200 sieve)	Gravels (More than 50% of coarse fraction retained on No. 4 sieve)	Clean gravels w/ < 5% fines <sup>E</sup>	$Cu \geq 4$ and $1 \leq Cc \leq 3$ <sup>C</sup>	GW	Well-graded gravel <sup>D</sup>
			$Cu < 4$ and/or $1 > Cc > 3$ <sup>C</sup>	GP	Poorly graded gravel <sup>D</sup>
		Gravels w/ > 12% fines <sup>E</sup>	Fines classify as ML or MH	GM	Silty gravel <sup>D,F,G</sup>
			Fines classify as CL or CH	GC	Clayey gravel <sup>D,F,G</sup>
	Sands (More than 50% of coarse fraction passes the No. 4 sieve)	Clean sands w/ < 5% fines <sup>I</sup>	$Cu \geq 6$ and $1 \leq Cc \leq 3$ <sup>C</sup>	SW	Well-graded sand <sup>H</sup>
			$Cu < 6$ and/or $1 > Cc > 3$ <sup>C</sup>	SP	Poorly graded sand <sup>H</sup>
		Sands w/ > 12% fines <sup>I</sup>	Fines classify as ML or MH	SM	Silty sand <sup>F,G,H</sup>
			Fines classify as CL or CH	SC	Clayey sand <sup>F,G,H</sup>
FINE-GRAINED SOILS (More than 50% passes the No. 200 sieve)	Silt and clays w/ liquid limit (LL) < 50	Inorganic	PI > 7 and plots on or above "A" line <sup>J</sup>	CL	Lean clay <sup>K,L,M</sup>
			PI < 4 and plots below "A" line <sup>J</sup>	ML	Silt <sup>K,L,M</sup>
		Organic	LL (Oven dried) / LL (Not dried) < 0.75	OL	Organic clay <sup>K,L,M,N</sup>
				OL	Organic silt <sup>K,L,M,O</sup>
	Silt and clays w/ liquid limit (LL) ≥ 50	Inorganic	PI plots on or above "A" line	CH	Fat clay <sup>K,L,M</sup>
			PI plots below "A" line	MH	Elastic silt <sup>K,L,M</sup>
		Organic	LL (Oven dried) / LL (Not dried) < 0.75	OH	Organic clay <sup>K,L,M,P</sup>
				OH	Organic silt <sup>K,L,M,Q</sup>
HIGHLY ORGANIC SOILS	Primarily organic matter, dark in color, and organic odor		PT	Peat	

<sup>A</sup> Based on the material passing the 3-inch (75 mm) sieve

<sup>B</sup> If field sample contained cobbles or boulders, or both, add "with cobbles or boulders, or both" to group name

<sup>C</sup>  $Cu = D_{60}/D_{10}$ ;  $Cc = (D_{30})^2 / D_{10} \times D_{60}$

<sup>D</sup> If soil contains ≥ 15% sand, add "with sand" to group name

<sup>E</sup> Gravels with 5 to 12% fines require dual symbols:

- GW-GM well-graded gravel with silt
- GW-GC well-graded gravel with clay
- GP-GM poorly graded gravel with silt
- GP-GC poorly graded gravel with clay

<sup>F</sup> If fines classify as CL-ML, use dual symbol GC-GM, or SC-SM

<sup>G</sup> If fines are organic, add "with organic fines" to group name

<sup>H</sup> If soil contains ≥ 15% gravel, add "with gravel" to group name

<sup>I</sup> Sands with 5 - 12% fines require dual symbols:

- SW-SM well-graded sand with silt
- SW-SC well-graded sand with clay
- SP-SM poorly graded sand with silt
- SP-SC poorly graded sand with clay

<sup>J</sup> If Atterberg limits plot in hatched area, soil is a CL-ML, silty clay

<sup>K</sup> If soil contains 15 - 29% plus No. 200, add "with sand" or "with gravel"

<sup>L</sup> If soil contains ≥ 30% plus No. 200, predominantly sand, add "sandy" to group name

<sup>M</sup> If soil contains ≥ 30% plus No. 200, predominantly gravel, add "gravelly" to group name

<sup>N</sup> PI ≥ 4 and plots on or above "A" line

<sup>O</sup> PI < 4 or plots below "A" line

<sup>P</sup> PI plots on or above "A" line

<sup>Q</sup> PI below "A" line

## RELATIVE SOIL COMPOSITION

- Trace - 0 - 15% of sample
- With - 15 - 35% of sample
- Soil modifier - > 35% of sample (i.e. sandy, silty, clayey, gravelly)

## DRILLING & SAMPLING SYMBOLS

- |                                 |   |
|---------------------------------|---|
| AU - Auger sample from cuttings | SS - Split spoon sample (2" O.D. by 1½" I.D.) |
| BS - Bag sample                 | ST - Shelby Tube sample (2" or 3" O.D.)       |
| HA - Hand auger sample          | WS - Wash sample from wash water return       |

## SOIL PROPERTY SYMBOLS

- N - N-value (blow count) is the standard penetration resistance based on the total number of blows required to advance a split spoon sampler one (1) foot, using a 140 lb. hammer with a 30 inch free fall. To avoid damage to sampling tools, driving is typically limited to 50 blows during any 6 inch interval. Additional description is provided below:

<u>N-value (bpf)</u>	<u>Description</u>
HW	Sampler penetrated soil under weight of hammer and rods; no driving required
25	25 blows to advance sampler 12 inches after initial 6 inches of seating
75/10"	75 blows to advance sampler 10 inches after initial 6 inches of seating
50/S3"	50 blows to advance sampler 3 inches during initial 6 inch seating interval

- |  |   |
|--|---|
| MC - Moisture content, %   | LL - Liquid limit, % (ASTM D4318)                   |
| Qu - Unconfined compressive strength, tons per square foot (tsf)     | PL - Plastic limit, % (ASTM D4318)                  |
| Qp - Calibrated hand penetrometer resistance, tsf                    | PI - Plasticity index, % (ASTM D4318)               |
| γ <sub>d</sub> - Dry density, pounds per cubic foot (pcf)            | %P200 - Percent of sample passing the No. 200 sieve |
| RQD - Rock quality designation of NX-size core sample                |   |
| RMR - Rock mass rating, as developed by Z.T. Bieniawski              |   |
| PID - Photoionization detector (Hnu meter) volatile vapor level, ppm |   |

## SOIL RELATIVE DENSITY & CONSISTENCY CLASSIFICATION

NON-COHESIVE SOILS		COHESIVE SOILS		
Density	N-Value Range	Consistency	Qu Range (tsf)	Approximate N-value Range
Very loose	0 - 3	Very soft	0 - 0.25	0 - 2
Loose	3 - 7	Soft	0.25 - 0.5	2 - 5
Medium dense	7 - 15	Medium stiff	0.5 - 1.0	5 - 10
Dense	15 - 38	Stiff	1.0 - 2.0	10 - 14
Very dense	38+	Very Stiff	2.0 - 4.0	14 - 32
		Hard	4.0+	32+

## SOIL STRUCTURE TERMINOLOGY

- |   |   |
|---|---|
| Interlayered - Alternating layers of different soil types | Intermixed - Pockets of different soil types, no layering       |
| Layer - Inclusion greater than 3 inches thick             | Pocket - Inclusion of material of different texture             |
| Seam - Inclusion ¼ to 3 inches thick                      | Varved - Alternating layers or seams of sand, silt, and/or clay |
| Laminated - Alternating seams of different soil type      |   |

## GROUNDWATER & MOISTURE CONDITIONS

- |  |  |
|--|--|
| ∇ - Approximate groundwater level as noted during drilling and sampling            | Dry - Absence of moisture, dry to the touch                    |
| ▼ - Groundwater level as noted within the open borehole upon removal of the augers | Moist - Damp, but no visible water                             |
| ¥ - Delayed groundwater level within open borehole                                 | Wet - Visible free water, saturated, usually below water table |

NOTE: General Notes have been adapted from and incorporate portions of ASTM D2487 "Classification of Soils for Engineering Purposes (Unified Soil Classification System)" and ASTM D2488 "Description and Identification of Soils (Visual-Manual Procedure)."